

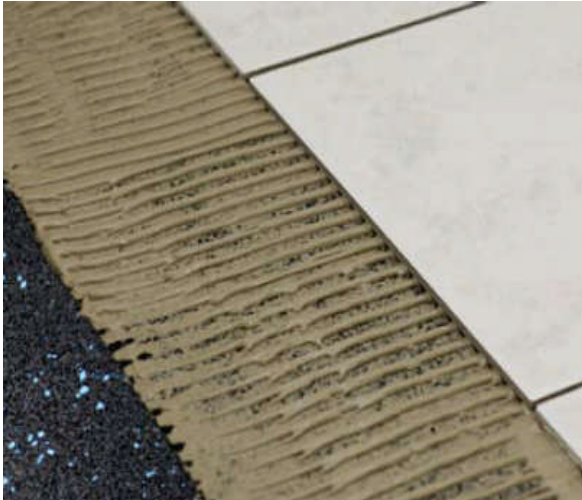

LATICRETE® AttenuMat-720 Sound Control Underlayment

LDS680aus.0



1. PRODUCT NAME

LATICRETE® AttenuMat-720 Sound Control Underlayment

2. MANUFACTURER

LATICRETE Pty Ltd
464 Geelong Road,
Footscray West. VIC. 3012.
Telephone: 03 99336111
Toll Free: 1800331012
Fax: 03 99336199
Email: laticreteoz@laticrete.com.au
Internet: www.laticrete.com.au

3. PRODUCT DESCRIPTION

LATICRETE AttenuMat-720 Sound Control Underlayment is a composite of recycled rubber particles and other selected sound attenuating granules to form a high density acoustical control mat is available in varying thickness to aid in sound transmission reduction in tiled and other types of internal floor installations.

Uses

For use in residential homes, apartments, hotels, shopping centres, airports, office building or where ever sound control is required. LATICRETE AttenuMat-720 is especially designed to be used under Thin-Bed

adhesive for interior floor installations of ceramic tile, marble, stone, brick, vinyl, parquetry and the like to reduce transmission of noise from one floor to the floor below.

LATICRETE AttenuMat-720 Sound Control Underlayment is a high performance acoustical underlayment system that muffles impact noises and reduces sound transmission through ceramic tiles, stone and other hard surfacing materials. LATICRETE AttenuMat-720 combines low installed weight with a minimal "above substrate" thickness. LATICRETE AttenuMat-720 should be applied to the entire substrate prior to the installation of ceramic tile, marble, stone, terrazzo and other suitable hard finishes.

Advantages

- Easy and fast to install with standard tools.
- Easy to cut to size.
- Ready for tiling relatively soon after installation
- Available in a variety of thicknesses and performance levels.
- Has a green footprint, consumes recycled rubber.

Suitable Substrates

- Concrete and concrete masonry
- Existing Tiles
- Compress cement sheet**
- Exterior grade plywood*
- Timber Floors
- Screeds and Mortar Beds

*Interior use only.

**Consult cement backer board manufacturer for specific installation recommendations and to verify acceptability for use.

Packaging

LATICRETE AttenuMat-720 Sound Control Underlayment

1.2m x 10m x 5mm thick, 16 rolls per pallet.

1.2m x 15m x 3mm thick, 20 rolls per pallet.

LATICRETE Premium 335 Cementitious Adhesive

20kg bags

56 bags to the pallet.

Approximate Coverage

5mm – 12m² per roll

3mm – 18m² per roll

Data sheets are subject to change without notice. For latest revision, check our website at www.laticrete.com.au

LATICRETE 335 will bond approximately 6 - 8m² of mat to a level surface per 20kg bag.

Shelf Life

Factory sealed packages of the AttenuMat-720 are guaranteed to be of first quality for two (2) years if stored off the ground at temperatures >0°C and <43°C.

Factory sealed containers of the Premium 335 are guaranteed to be of first quality for one (1) year if stored off the ground in a dry area. High humidity will reduce the shelf life of bagged product.

Limitations

- For horizontal use over suitable interior substrates only.
- This product should not be stored in direct sunlight. If necessary to store outdoors cover with tarpaulin and provide adequate ventilation.
- Apply a LATICRETE waterproof membrane over the mat when used in wet area work.
- Mats should be bonded to substrates prior to thin or thick bed tile installations being made, including the application of mortar beds.
- DO NOT DOUBLE STACK PALLETS
- Best results are obtained when underlayment is installed at temperatures above 4°C and below 32°C
- Not for use over expansion joints or structural movement cracks.
- Adhesives/mastics, mortars and grouts for ceramic tile, pavers, brick and stone are not replacements for waterproof membranes. When a waterproof membrane is required, use a LATICRETE Waterproof Membrane over the LATICRETE AttenuMat-720 Sound Control Underlayment.
- Note: Surfaces must be structurally sound, stable and rigid enough to support ceramic/stone tile, thin brick and similar finishes. Substrate deflection under all live, dead and impact loads, including concentrated loads, must not exceed L/360 for thin bed ceramic tile/brick installations or L/480 for thin bed stone installations where L = span length.
- Tiles fixed directly to mats should be generally larger than 200 x200 in size. This may vary however depending on mat thickness and density. Consult LATICRETE.

Cautions

- Keep out of reach of children.
- During cold weather, protect finished work from traffic until fully cured.
- For green marble, resin backed or other moisture sensitive tile or stone use LATAPOXY 300 Adhesive.
- Dimensionally unstable, water sensitive or UV sensitive stone or tile may cause delamination of the mat in thin-set applications through warping or curling of the finished veneer.

- For white or light coloured marbles use LATICRETE 335 White.
- Do not use solvents to prepare substrates or remove adhesive residues.

4. TECHNICAL DATA

Physical Properties

Property	Values
Total Thickness	5mm and 3mm
Density	720kg/m ³
Colour	Black

Sound Attenuating Properties as per AS ISO 717.2-2004, ISO 140-8-1997 (E) & ISO 140-8

Product	5mm mat with Latascreed bed and tiles over	5mm mat with thinset fixed tiles over
Delta ΔLw (dB) reduction	18	13
Ln,w + Ci Result	59	62

Tests were performed by the CSIRO at the Highett facility on a 150mm thick slab with no ceiling below - June 2008. Porcelain tiles were thin-set installed over mat or screed with LATICRETE 335 adhesive and then pointed with LATICRETE grout prior to the test.

Product	5mm mat with 14mm engineered timber over, direct stick	3mm mat with 2mm Vinyl Plank over, direct stick
Delta ΔLw (dB) reduction	18	20
Ln,w + Ci Result	59	57

Tests were performed by the CSIRO at the Highett facility on a 150mm thick slab with no ceiling below - June 2008. Finishes were direct stuck with 1 part polyurethane adhesive. Call LATICRETE for installation details with polyurethane adhesives.

Specifications subject to change without notification. Results shown are typical but reflect test procedures used. Actual field performance will depend on installation methods and site conditions.

5. INSTALLATION

Concrete shall be a minimum of 28 days old and shall be dry. The surface shall have a smooth wood float finish and be free of voids, sharp protrusions and loose aggregates. All surfaces should be between 4°C and below 32°C and structurally sound, clean and free of all dirt, oil, grease, paint, concrete sealers, curing compounds, laitance or anything else that may inhibit

Data sheets are subject to change without notice. For latest revision, check our website at www.laticrete.com.au

bond. Rough or uneven concrete should be made smooth with a LATICRETE Latex Portland cement underlayment to provide a wood float finish. Do not level with gypsum or asphalt based products.

Application

Perimeter Isolation Strip

It is essential that all walls and other building elements are isolated from the floor. It is required to install a strip of AttenuMat-720 to the known final finished floor level or above for trimming latter to the entire installation perimeter. This also includes any protrusion or abutment within the works to isolate or break the vibration transmission path between the floor and wall or upturn.

This is installed prior to the floor mat. The formation of complete voids for filling with acoustic caulking is also an acceptable method of perimeter isolation.

LATICRETE AttenuMat-720 Sound Control

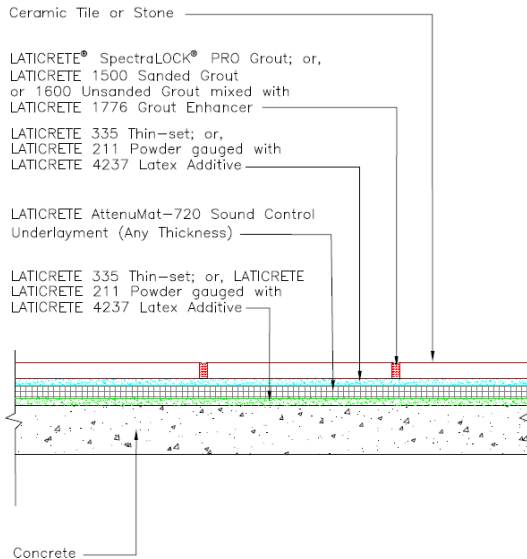

Thin-set application over LATICRETE AttenuMat-720

Use LATICRETE 335 Multi Purpose Thin-Set Adhesive to adhere the AttenuMat-720 to the substrate. Use a 6mm x 6mm notched trowel and comb mortar over substrate, apply only enough mortar as can be covered within 15 minutes. Unroll the AttenuMat-720 into place, in the thin-set adhesive mortar. Once installed, use a 10 to 20kg roller to embed the AttenuMat-720 firmly into the thin-set adhesive mortar. Allow to cure as per the instructions on the 335. Continue to install the AttenuMat-720 over the rest of the area to be treated, do not overlap edges but be sure edges of each piece butt firmly together. Trim lengths of mat to desired length and width. Once fully

cured, install ceramic tile, porcelain or stone finish directly over the AttenuMat-720 using LATICRETE 335 Multi Purpose Thin-Set Adhesive. Follow the instructions on adhesive packaging.

Laticreed or mortar bed application over LATICRETE AttenuMat-720 Installation

Use a minimum 20mm thick LATICRETE Laticreed mortar bed or a minimum 40mm thick sand cement bed directly over the AttenuMat-720.

Mixing

Prior to applying the mortar beds prepare a well mixed bond coat of LATICRETE Latabond and Portland cement at the rate of 40kgs of Portland cement to 20 litres of LATICRETE Latabond.

Mix the LATICRETE Laticreed at the rate of approximately 2.1litres of LATICRETE Latabond for every 20kgs of dry mix. Adjust ratio to suit requirements. Mixing by a rotating paddle, drum mixer is preferred.

Non proprietary mortar beds should consist of 3:1 site mixed sand and Portland cement. Use only sufficient water or LATICRETE Latabond to hydrate mix. Beds that exceed 50mm in thickness should be laid in two layers with the appropriate steel reinforcing installed.

Application

Apply bond coat only to areas that are to be immediately covered by the mortar beds. Do not allow bond coat to dry out and skin prior to application of mortar bed. Apply with a stiff broom or brush to work the bond coat into the mat and leaving a nominally 2mm thick wet and tacky coating.

Immediately cover the wet and tacky bond coat with the premixed Laticreed or non proprietary mortar compacting and striking off to the desired levels and falls to a wood float finish. Allow to cure prior to fixing tiles or other finishes including timber floors and carpet.

Note: Never mechanically fasten any material through the AttenuMat-720. Mechanical connections such as nails, screws, staples and the like will transmit noise through the building structure and compromise the sound control ability of the AttenuMat-720.

Small format tiles including large mosaics are not suitable for direct adherence to the AttenuMat-720.

Make sure the AttenuMat-720 installation is cured for 24 hours at 21°C prior to allowing foot traffic to occur without movement of the mat.

6. AVAILABILITY AND COST

Availability

LATICRETE® and LATAPOXY® materials are available worldwide. For distributor information:

Toll Free: 1800331012

Melbourne Telephone: 03 99336111
Brisbane Telephone: 07 38651599

Cost

Contact a LATICRETE Distributor in your area.

7. WARRANTY

LATICRETE International, Inc. warrants that LATICRETE® AttenuMat-720 Sound Control Membrane is free from manufacturing defects and will not break down, deteriorate or disintegrate under normal usage for a period of ten (10) year from date of purchase subject to the terms and conditions stated in Data Sheet 230.10Paus LATICRETE Product Warranty.

8. MAINTENANCE

LATICRETE and LATAPOXY grouts require routine cleaning with a neutral pH soap and water. All other LATICRETE and LATAPOXY materials require no maintenance but installation performance and durability may depend on properly maintaining products supplied by other manufacturers.

9. TECHNICAL SERVICES

Technical assistance

Information is available by calling:
Toll Free: 1800331012
Telephone: 03 99336111
FAX: 03 99336199

10. FILING SYSTEM

Additional product information is available on our website at; www.laticrete.com.au

Related documents;

1. LDS 335.0aus: LATICRETE Flexible Premium 335 Cementitious Adhesive.